

**Aristo**  
Developers

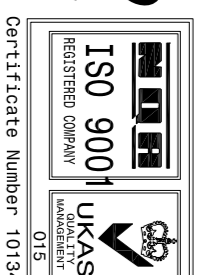

ARCHITECTS-CONTRACTORS-DEVELOPERS

REV. 1.11 V14 (23/01/08)  
ADDITION OF ROAM STEPS TO THE POOL.  
REV. 1.12 V14 (28/07/08)  
REMOVAL OF ROAM STEPS TO THE POOL.  
REV. 1.13 (28/02/08)  
METAKANAKH FINISH TO THE N17  
AWAHI FINISH TO THE N17  
AWAHI FINISH TO THE N17  
REV. 1.15 V14 (11/02/08)  
ADDITION OF ROAM STEPS TO THE POOL.  
REV. 1.16 V20 (02/07/08)  
SWIMMING POOL SURFACE LEVEL (1.80 METERS)  
REV. 1.17 V14 (04/07/08)  
REMOVAL OF ROAM STEPS TO THE POOL.

REV. 1.8 (14/07/08)  
ANFOUR PLATOTE ΔΡΟΜΟΥ ΕΕ 8.55M  
REV. 1.9 (09/09/08)  
ANFOUR PLATOTE ΔΡΟΜΟΥ  
REV. 1.10 (09/09/08)  
ANFOUR PLATOTE ΔΡΟΜΟΥ  
REV. 1.11 (13/11/08)  
ANFOUR PLATOTE ΔΡΟΜΟΥ  
REV. 1.12 (22/05/09)  
AWAHI GETHI TROTIKAKOT A.H.K.  
REV. 1.14 (08/06/08)  
AWAHI GETHI TROTIKAKOT A.H.K.  
REV. 1.25 V14  
AWAHI GETHI TROTIKAKOT A.H.K.  
REV. 1.26 (08/08/09) V13 02611  
SWIMMING POOL TO HAVE CUT CORNERS  
REDUCED PANTO BY THE ENTRANCE AREA  
RELOCATED TO THE GARDEN AREA  
REV. 1.27 (08/08/09) V13 02610  
ROMAN SEMICIRCULAR PLASTIC WALKER STEPS  
FOR THE SWIMMING POOL APPROX. 8M WIDE  
REV. 1.28 (23/08/11) V13 02611  
PROVISIONS FOR 24 LIGHTS ALONG THE GREENWAY WALL ON  
THE RIGHT WITH WATERPROOF SWITCH BY EXTERNAL STEPS  
EXTRA WATERPROOF SOCKET TO THE GARDEN AREA  
REPOSITION THE LIGHT PROVISIONS AROUND THE POOL  
WITH ADDITIONAL SWITCH IN THE MASTER BEDROOM TO  
CONTROL THESE LIGHTS  
REV. 1.29 (12/08/11) V13  
TOGETHER DELAY AND ON A PARTITION  
REV. 1.30 (19/08/11) V13 02611  
REV. 1.31 (19/08/11) V13 02611  
KAI ANFOURONIKON ANON  
REV. 1.32 V14  
REV. 1.33 (09/10/16)  
AWAHI APOULI, EIMVINDI AIO V1 3E V1A

NOTE: The company is obligated to update the design bill has been  
agreed with each client. On the remaining project changes may occur.

**R. ARISTODEMOU**  
ARCHITECTS - ENGINEERS

8 Aprilou, 1st Str., P.O.Box:60269, 8101 Podos, Cyprus  
Tel: +357 26 932503 / 932388, Fax: +357 26 938290  
E-mail: aristo@aristodevelopers.com  
URL: http://www.aristodevelopers.com

Rev	Study & Design	Drawn by	Inspected by	Date
1.29	Architect Assistants	A. MICHAEL	R. ARISTODEMOU	12/08/11
1.30	K. ASIDES	T.SIOTTA 201	R. ARISTODEMOU	31/08/12
1.31	Architect	A. MICHAEL	R. ARISTODEMOU	08/10/12
1.32	K. ASIDES	CHRISTINA	R. ARISTODEMOU	18/09/15
1.33	Architect	CHRISTINA	R. ARISTODEMOU	20/10/16

Project: AGNADESS VILLAGE N.1  
Location: NHO CHORIO  
Type: VILLAS  
Job No: 922  
Sheet No: A1  
Scale: 1:500  
Date: (cm)

Title: MASTER PLAN

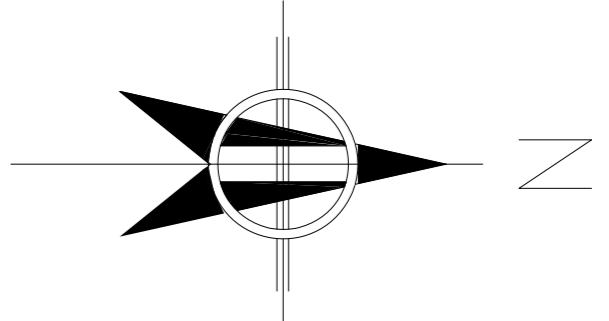
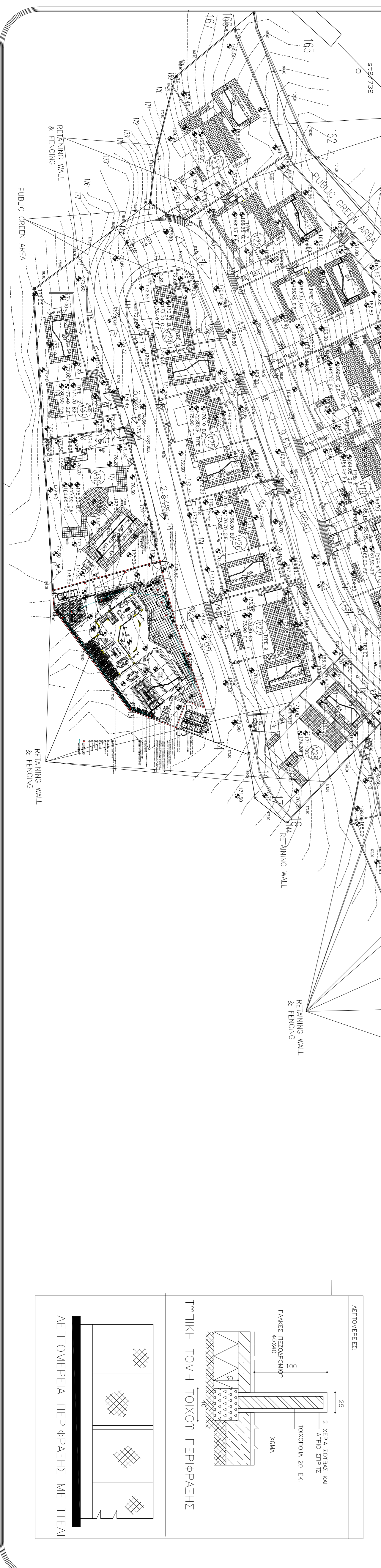

REV. 1.2 (16/01/07)  
PROIΓHSH TROTIKAKOT A.H.K.  
REV. 1.6 (07/12/07)  
AWAHI ΔΡΟΜΩΝ ΚΑΙ ΤΡΟΚΕΠΩΝ ΑΙΩ ΠΟΔΕΩΔΩΜΑ  
REV. 1.7 (02/01/08)  
AWAHI EIMVINDI TIO N.11  
REV. 1.8 (15/01/08)  
AWAHI EIMVINDI TIO N.12  
AWAHI EIMVINDI TIO N.18, N.24, N.25, N.26, N.27, N.28  
AWAHI EIMVINDI TIO N.10, N.12, N.13

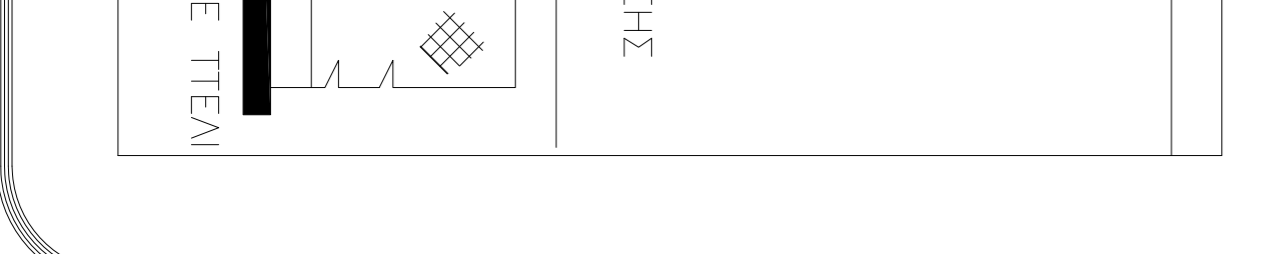

\\Storage\architectural projects\Υποδομ\ΣΧΕΔΙΑΣΤΕΣ\WLDG N\WLDG PLAN.rvt